

CONFIDENTIAL - For internal use only

Symbol **+PLUS**
VALIDATED

StepOne
StepOne 1.0 Simulator

Validation Report
December 15, 2005

Table of Contents

1.	EXECUTIVE SUMMARY	3
1.1.	About StepOne	3
1.2.	Test Objectives	3
1.3.	Conclusion	3
2.	VALIDATION DETAILS	4
2.1.	Testing Environment	4
3.	TESTING PROCEDURE	5
3.1.	Validation Overview	5
3.2.	Validation Results	5
4.	VALIDATION EQUIPMENT	6
5.	ABOUT SYMBOL PLUS VALIDATION	7
6.	ABOUT MOTOROLA ENTERPRISE MOBILITY BUSINESS (FORMERLY SYMBOL TECHNOLOGIES)	7
7.	DISCLAIMER	7

1. Executive Summary

StepOne Inc. has successfully completed the Symbol PLUS Validated program for their StepOne 1.0 emulator. Testing was jointly performed at the Symbol Solution Center located in Holtsville, NY on 12/15/2005. Validation was performed on several Symbol mobile devices over Symbol wireless LAN infrastructure.

1.1. About StepOne

The Symbol Terminal Enabler Program (STEP) resides in a Symbol radio terminal and executes a pre-defined set of commands sent from an application program in a host computer. As STEP executes the host commands in the terminal, the terminal operator is guided through the data-entry process.

1.2. Test Objectives

The main testing objective was to ensure that the StepOne platform works out of the box on the Symbol devices under test including the following:

The StepOne client could be installed on Symbol Mobile Device.

The StepOne client could update the backend systems properly through WLAN.

The StepOne client could handle barcode data.

The StepOne client user interface and navigation work as designed.

1.3. Conclusion

StepOne Inc. has successfully met all test objectives and is granted the Symbol PLUS Validated logo.

2. Validation Details

2.1. Testing Environment

Symbol provided and pre-configured all of the equipment shown in the following test environment diagram with the exception of the laptop computer. StepOne Systems provided the laptop computer system which was pre-configured to contain all the necessary application testing software. The laptop and the terminals were co-located in the same ISV test bench area so that both could be viewed simultaneously. The rest of the infrastructure equipment and the DHCP/TFTP server were located in the lab's data center.

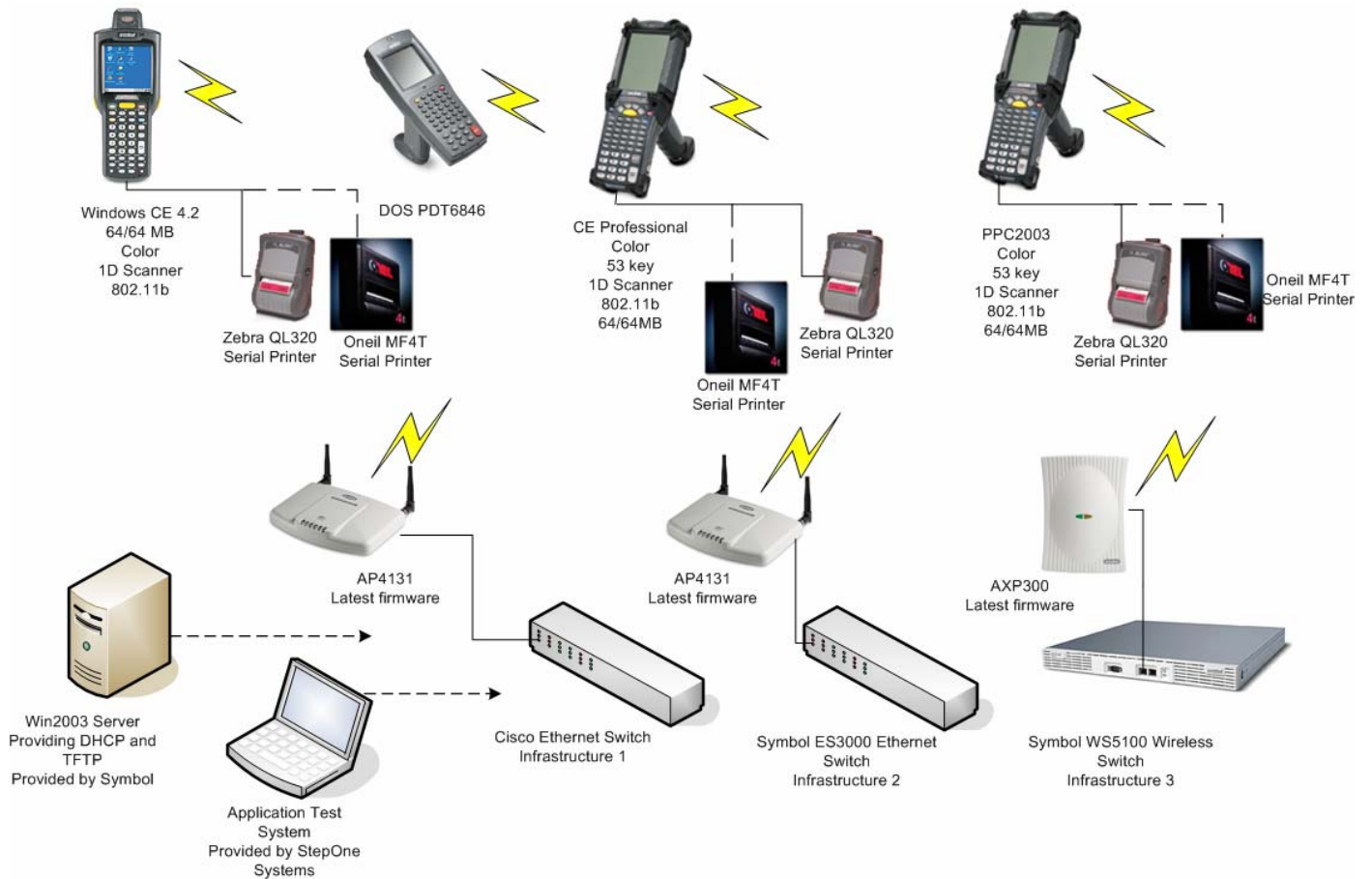

StepOne Systems – STEP Product Testing Environment

3. Testing Procedure

3.1. Validation Overview

Validation process exercised the StepOne client and its interface with the Symbol platform to demonstrate Symbol Terminal Enabler Program emulator could run on the Symbol Pocket PC and Windows CE devices.

3.2. Validation Results

StepOne client was installed on the Symbol mobile device via active sync connection. StepOne Systems provided the laptop computer system which was pre-configured to contain all the necessary application testing software. The mobile devices were configured to associate to the WLAN network using the WEP 128 bit encryption. The Step application was installed and number of barcodes was scanned. The navigation flow of the application was tested by using the mobile terminal keyboard. The application was also tested for printing using Oneil MF4T and Zebra printer.

StepOne client was successfully installed on the Symbol mobile device. After the installation the application was set to read 1D barcodes. Number of sample barcodes was scanned without any error. The audio was tested by scanning a barcode that triggered a beep. The navigation work flow worked as documented. The application was able to print successfully to the Oneil and Zebra printer via a serial connection. The wireless connectivity was tested using the AP 4131 and also AP 300 connected to WS5000 and WS3000. In the both the cases the connection worked flawlessly.

The StepOne application was tested for cold boot persistency by doing a cold boot and replacing the battery. The application did not get uninstalled on the mobile device and worked normally after the cold boot.

4. Validation Equipment

The following equipment was used during validation:

MOBILE COMPUTERS		WLAN	WWAN		Bluetooth
			GPRS (Cingular)	CDMA (Verizon)	
1	MC9060-GF0HBEEA4WW (PPC)	802.11b	none	none	none
1	MC9060-GF0HBGB00WW (CE Pro)	802.11b	none	none	none
1	MC3070-RG0PBBB00WW (CE 4.2)	802.11b	none	none	none
1	PDT 6846 (DOS)	802.11b	none	none	none

SCANNERS
Uses terminal's integrated scanner.

Scanning Note: STEP operates directly with the integrated scanner using typical 1D retail barcode symbologies.

WIRELESS INFRASTRUCTURE
802.11b via Symbol AP4131
802.11b/g via Symbol AP300 and WS5100

3rd PARTY PERIPHERALS
Cisco Ethernet switch – Catalyst 2950 or similar
Symbol Ethernet switch – ES3000
Zebra QL320 serial printer and appropriate adapter cables for MC9060 and MC3070
Oneil MF4T printer, configured for serial operation, with appropriate cables for MC9060 and MC3070

5. About Symbol PLUS Validation

The Symbol PLUS Validation service is a benefit offered to members of the PartnerSelect program and certain Motorola customers that entitle them to co-test their integrated solution. This validation test assures customers of high quality and system interoperability. Members of the Motorola Solutions Division work with a partner at the Solutions Center testing facilities to validate partner's integrated end-to-end solution using Motorola (formerly Symbol products) including mobile devices, wireless infrastructure and mobility management software. Detailed test cases are constructed to exercise the intended functionality under a variety of customer usage scenarios. Upon successfully completing the test objectives, the partner's solution is granted the Symbol PLUS Validated solution logo.

6. About Motorola Enterprise Mobility Business (Formerly Symbol Technologies)

Motorola is known around the world for innovation and leadership in wireless and broadband communications. Inspired by our vision of Seamless Mobility, the people of Motorola are committed to helping you get and stay connected simply and seamlessly to the people, information, and entertainment that you want and need. We do this by designing and delivering "must have" products, "must do" experiences and powerful networks -- along with a full complement of support services. A Fortune 100 company with global presence and impact, Motorola had sales of US \$35.3 billion in 2005. For more information, please visit <http://www.Motorola.com>

7. Disclaimer

Motorola Inc. ("Motorola") makes no expressed or implied representation or warranty with respect to: (i) any of the products referenced herein (the "products"); (ii) the information provided herein (including without limitation the key findings and test results regarding the products and the functionality or interoperability thereof) ("information") or any solution, combination or system that may be created with the use thereof.

The user of the products and the information is using at its own risk.

Motorola disclaims all other expressed and implied warranties including, without limitation, the implied warranties of noninfringement, merchantability and fitness for a particular purpose. The information is offered "as is" with all faults and does not constitute professional, technical, legal or other advice to the user.

 **MOTOROLA** MOTOROLA and the Stylized M Logo are registered in the US Patent & Trademark Office. All other product or service names are the property of their respective owners. © Motorola, Inc. 2007